

Part Number: R-HM22-28-02-L

Part Description: HIMALAYAN 410 2022

Installation / Parts List / Bill of Material for Mounting

NO.	Description	Quantity	Torque*(N-M)	Remarks**
1	LH - oil tank bracket	1		
2	Socket button head screw M5x25mm	4	5-6	Use Liquid Thread Locker
3	Washer M5	4		
4	Rubber Sheet	3		
5	AD-PART-OIL-Tank-01	2		
6	BLACK CABLE TIE	4		
7	Oil-Tank-2	1		
8	Oil-Tank-3	1		
9	Oil-Tank	1		
10	Hex flange nut gradea M5	4		
11	Nut plate	2		
SRC Design uses Metric System of Measurement and all dimensions in Millimeters				
Recommended to use the Torque specified in the table Denotes Usage of Liquid Thread Locker in specified Locations				

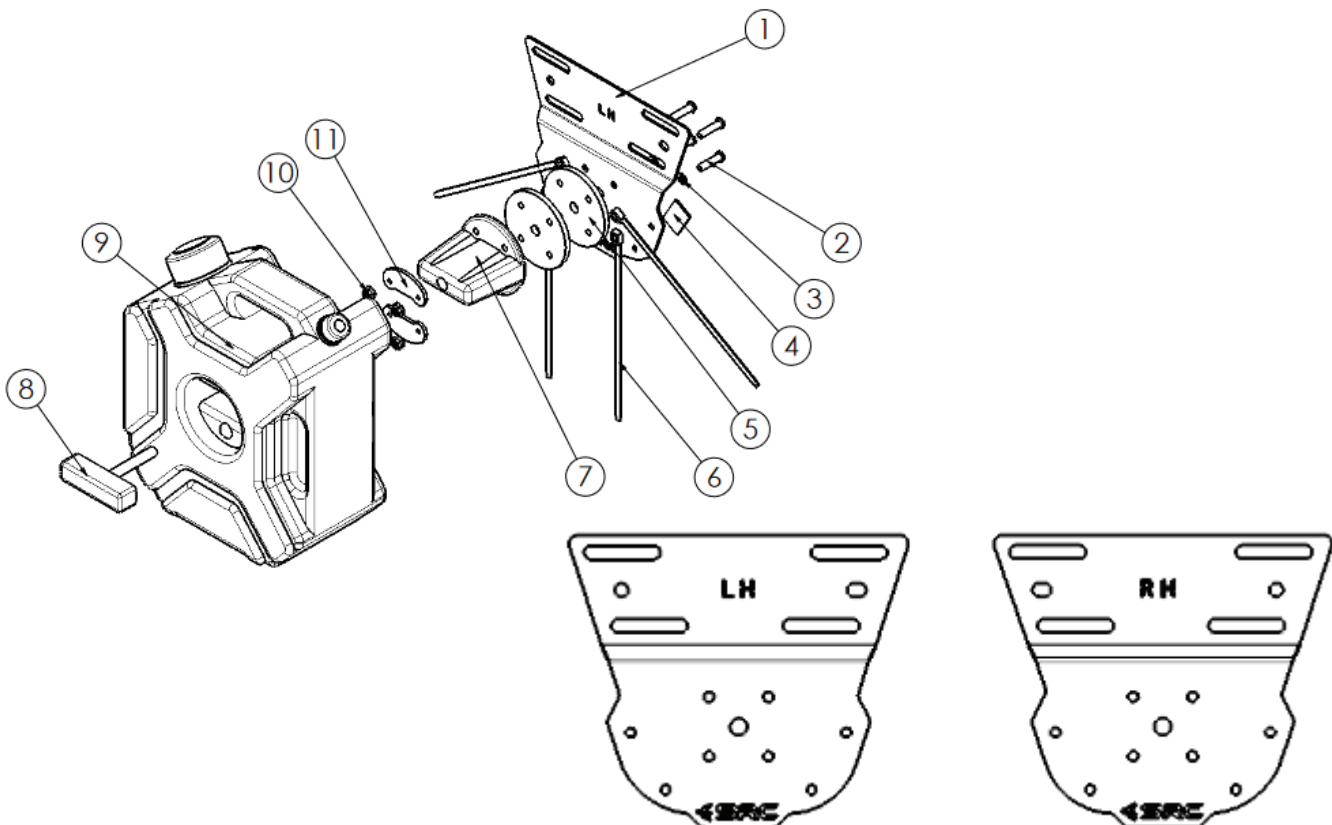

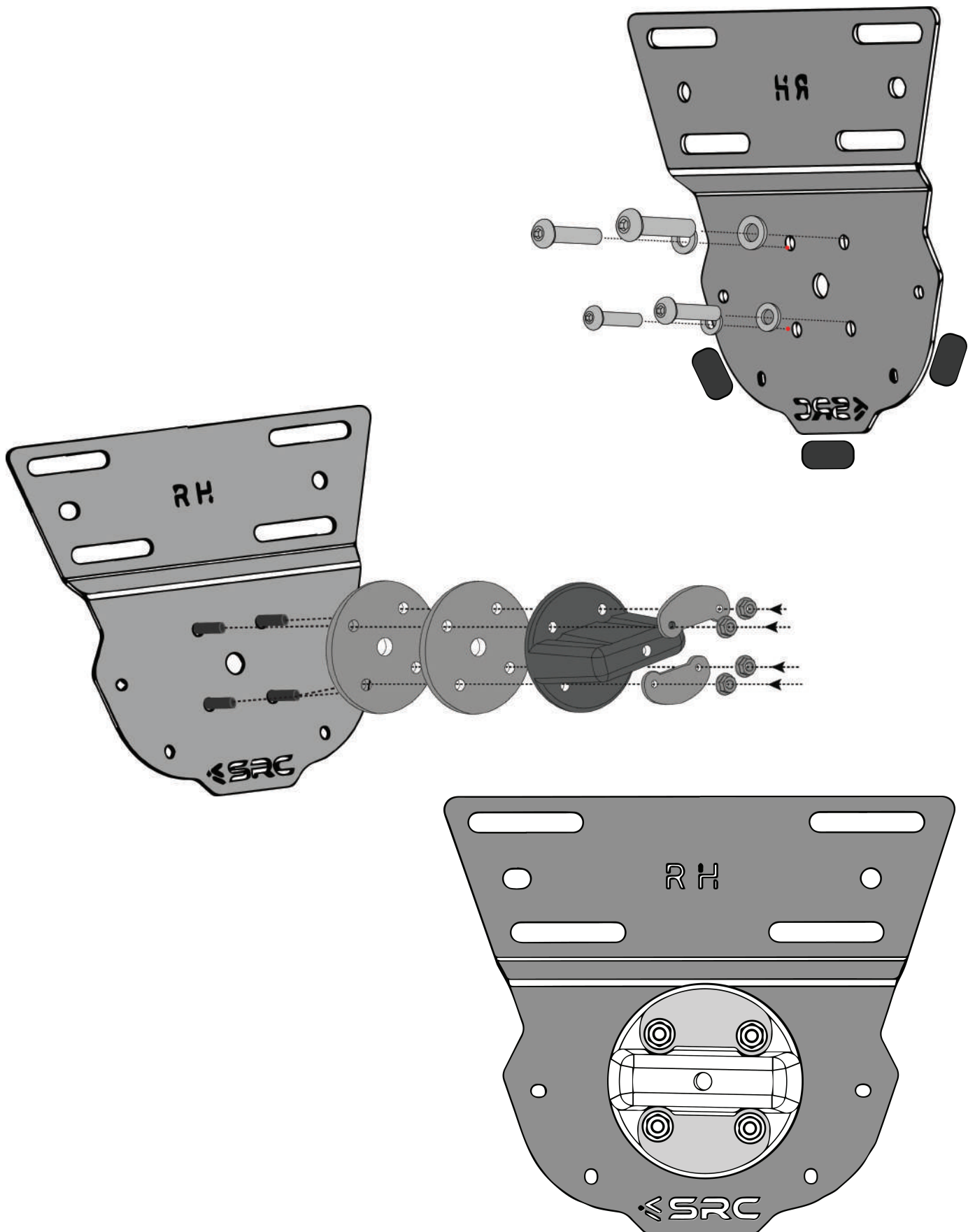

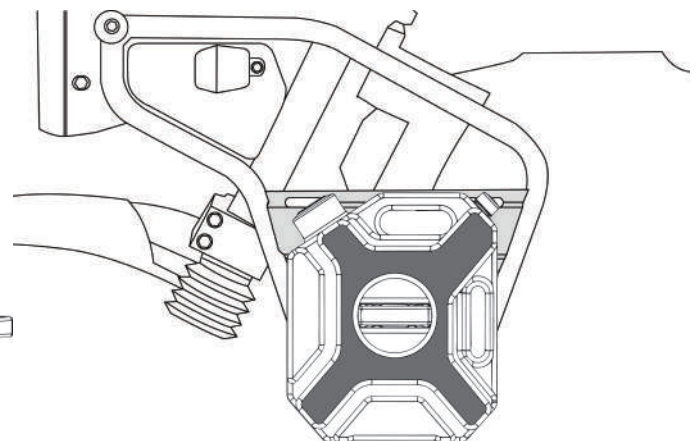
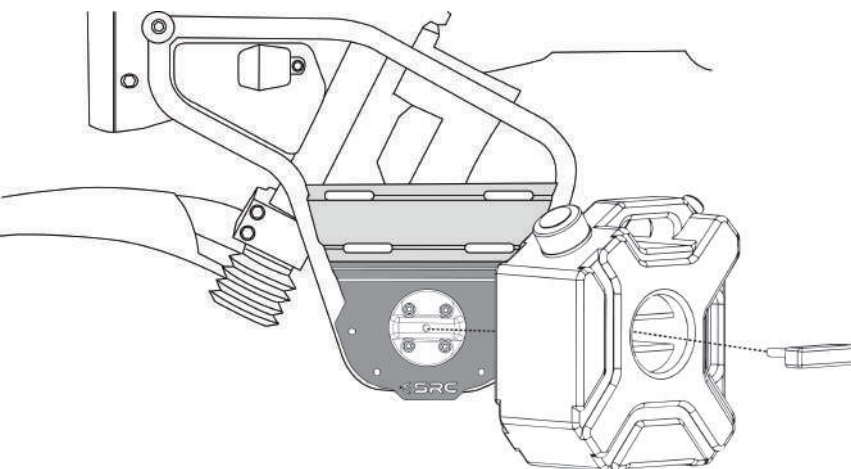
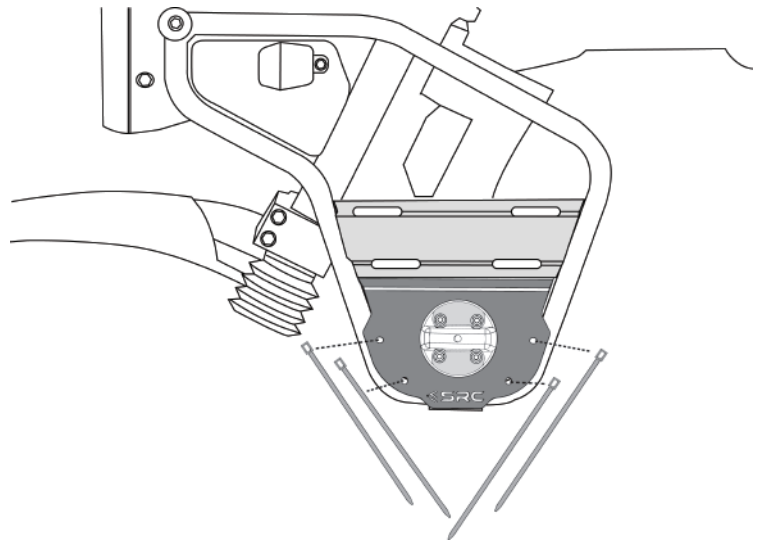
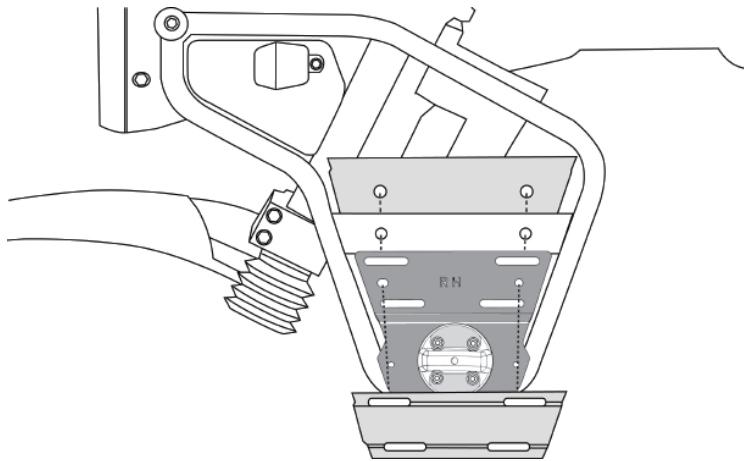
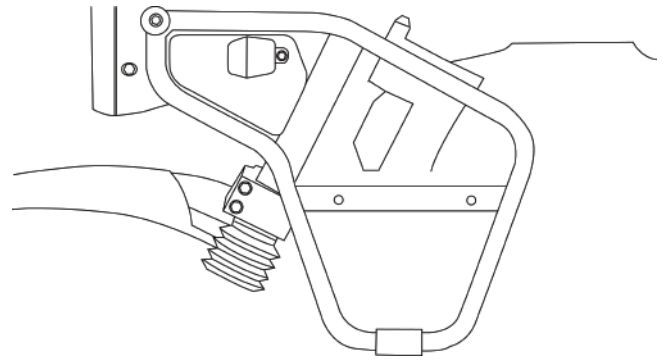
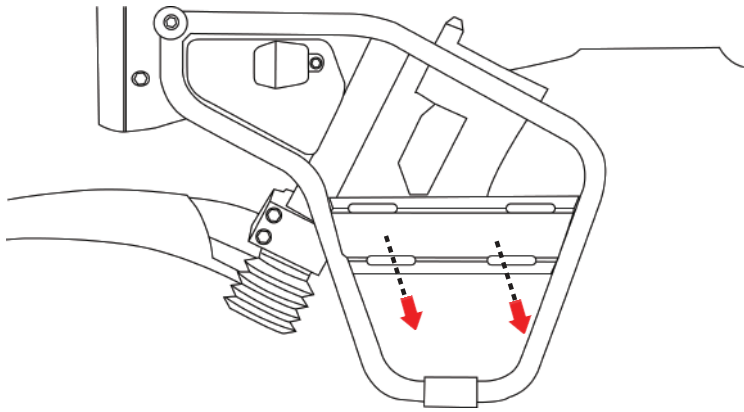

Mounting Instructions

Put parts
(socket button head screw m5x25mm)
and parts(washer m5)
on parts(LHorRH oil tank bracket).

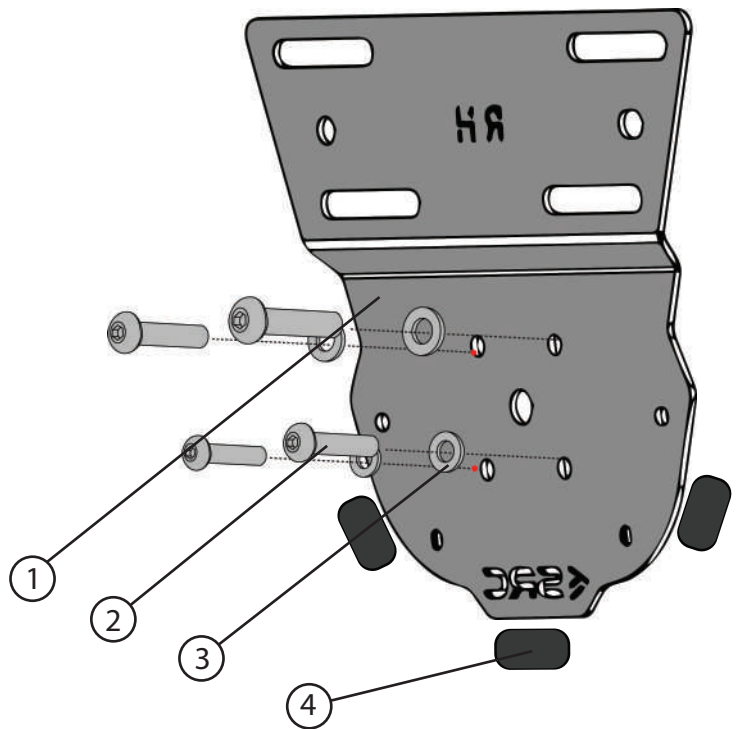

Assemble the parts as shown in the picture.

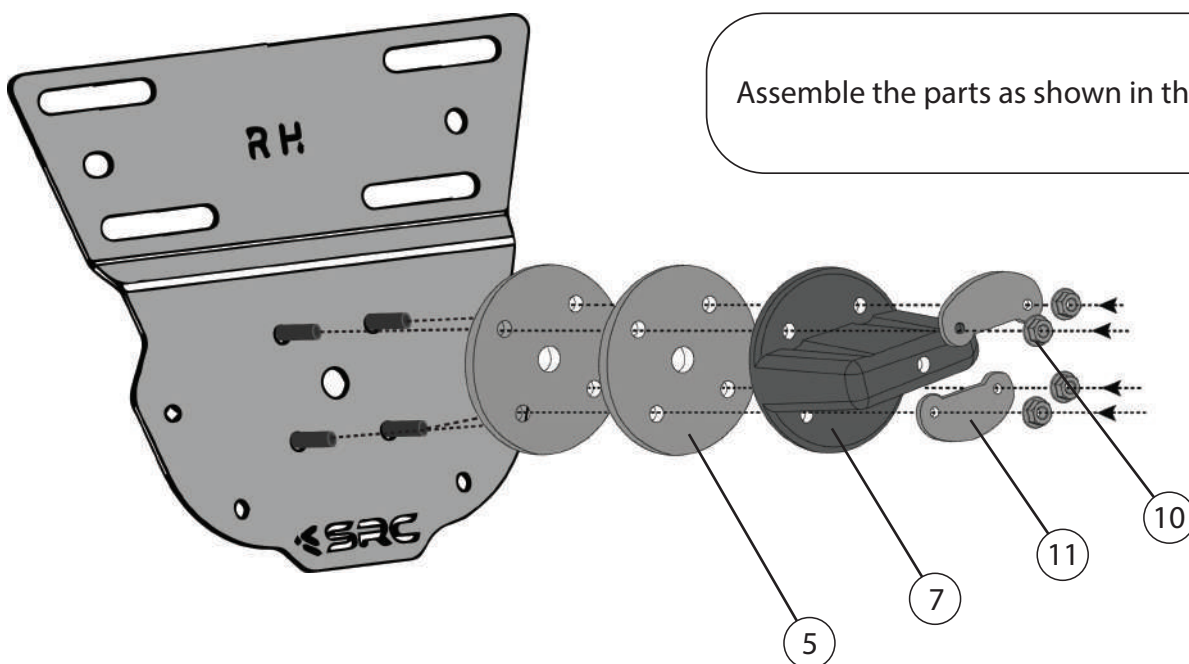

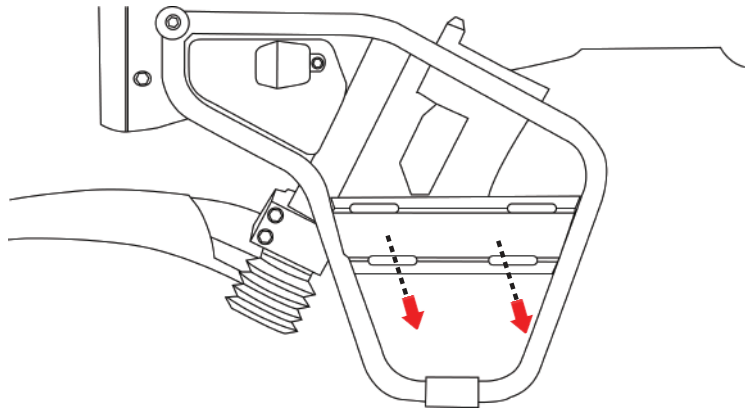

Remove the original parts from the motorcycle.

take the assembled parts Comes assembled with the original place as shown in the picture.

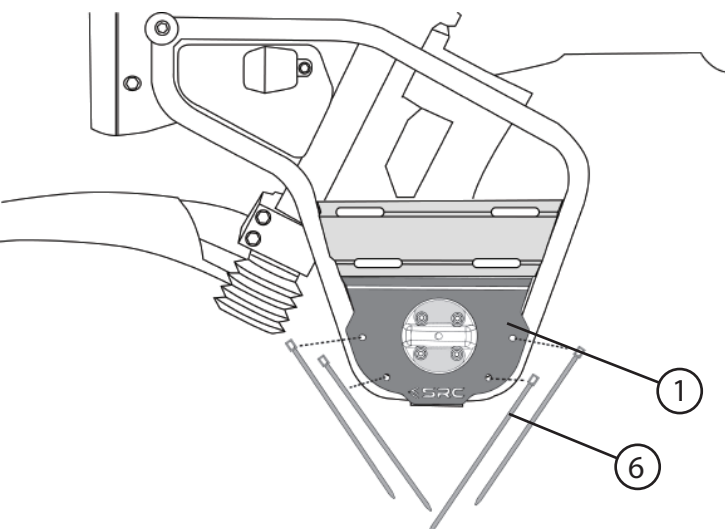
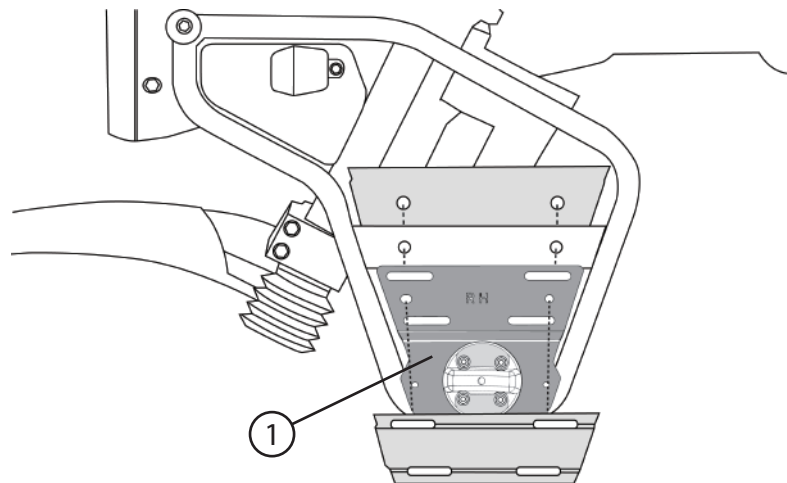

Bring (Black cable tie) to attach to the motorcycle.

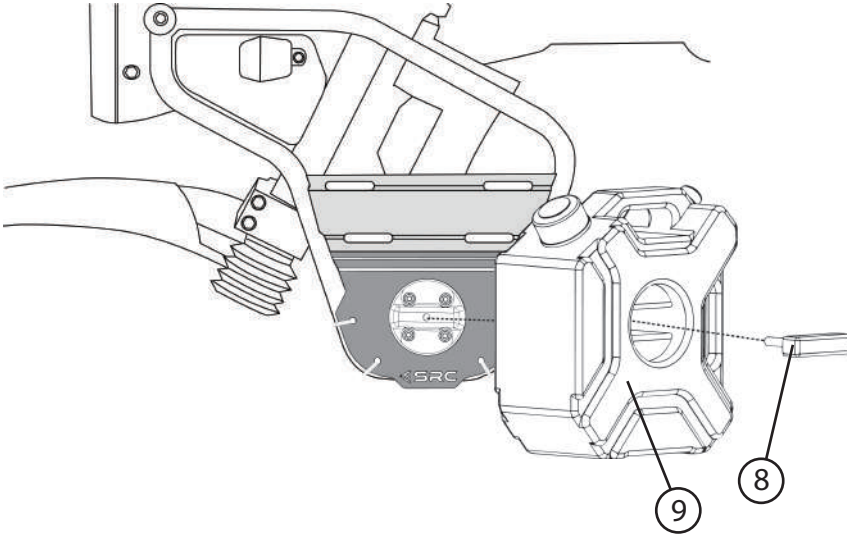

Take the fuel tank in and after that use the (oil-Tank-3) dial to fit it firmly in your hand.

Check and check the tightness of the assembled parts.

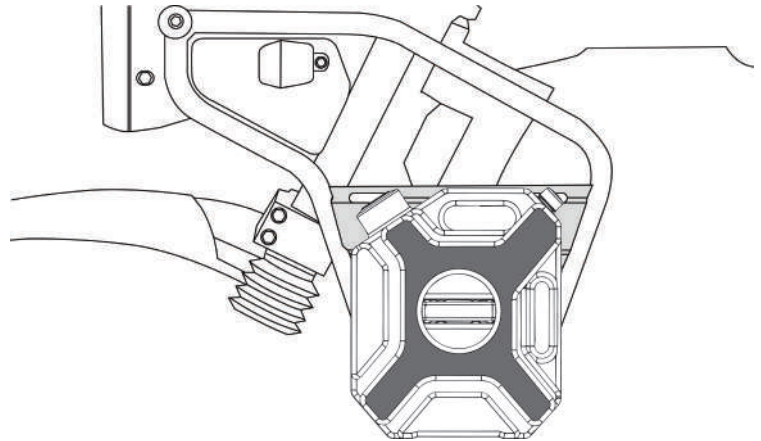



General Instructions

1. We request you to pay attention to the Mounting Instructions in this document and follow the step-by-step procedures.
2. This Mounting Instruction manual is a "Do It Yourself" (DIY) fitment manual of the Accessory part to the Vehicle. We have prepared this based on our experience and knowledge, related to the Vehicle, Part and its functional aspects.
3. SRC cannot guarantee the interchangeability of the parts to any other manufacturer's accessory part. It is advised to the User, to inspect and ensure the original state of all other Vehicle parts.
4. We request you to bear in mind, that the Installed part can change the driving behaviour and/or the stability during driving or any other dynamic conditions.
5. If you have the appropriate tools and another person to assist you in the mounting, it will help.
6. After Completion of the Mounting and before taking on a First ride, Ensure and Check all functions of the Vehicle. It is always advised to check loosening of the fasteners after the first 50 kilo meters of ride and at regular intervals.
7. To the maximum extent possible, our design use the current Mounting/Fitment of the Original Equipment, so that Installation of these accessories will not affect the Payload or Function of the Vehicle or the Part on which it is mounted to protect it
8. If any additional modifications are to be done, prior to the fitment of the accessories, it will be explicitly specified in the instruction sheets